

YARD LIGHT/PANEL RACK POLE: 3-3\"/>

CONTROL PANEL SHALL BE IN COMPLIANCE WITH CITY OF LEESBURG SECTION 7 OF THE WRITTEN STANDARDS.

BREAKER STYLE DISCONNECT ON SERVICE SIDE OF METER
METER BY ELECTRIC UTILITY COMPANY
LIGHTING ARRESTER SHALL BE INSTALLED IN DISCONNECT PANEL (G.E. OR EQUAL)

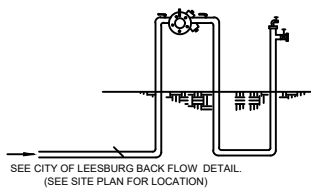

CONCRETE
1\"/>

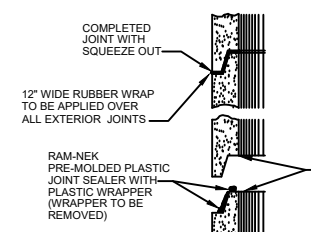

TONGUE AND GROOVE JOINT TYPICAL DETAIL

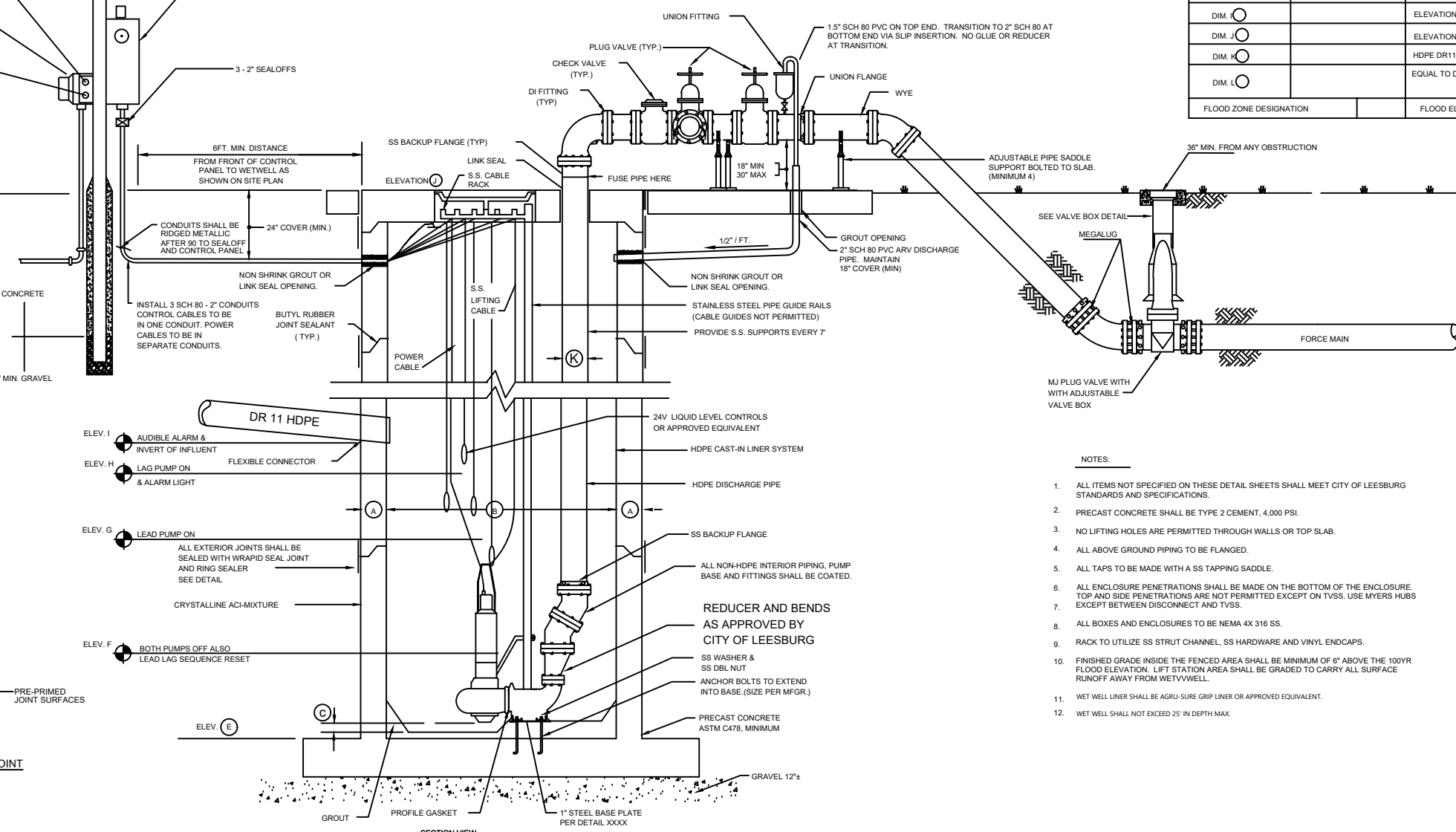

MARK	DIMENSIONS	DESCRIPTION	COMMENTS
DIM. A	○	WETWELL WALL THICKNESS	8" MINIMUM
DIM. B	○	WETWELL DIAMETER	8" MINIMUM
DIM. C	○	PER PUMP SUBMITTAL DATA	
DIM. D	○	SEE TOP SLAB DETAIL	
DIM. E	○	ELEVATION	BOTTOM OF WETWELL
DIM. F	○	ELEVATION	PUMPS OFF
DIM. G	○	ELEVATION	LEAD PUMP ON
DIM. H	○	ELEVATION	LAG PUMP ON
DIM. I	○	ELEVATION	AUDIBLE ALARM & INVERT
DIM. J	○	ELEVATION	TOP OF SLAB
DIM. K	○	HDPE DR11 DIAMETER	DISCHARGE
DIM. L	○	EQUAL TO DEPTH OF WETWELL.	15' MIN W/ NO ODOR CONTROL 20' MIN W/ ODOR CONTROL REQ'D
FLOOD ZONE DESIGNATION		FLOOD ELEV.	VERT DATUM "NAVD"

- NOTES:
- ALL ITEMS NOT SPECIFIED ON THESE DETAIL SHEETS SHALL MEET CITY OF LEESBURG STANDARDS AND SPECIFICATIONS.
 - PRECAST CONCRETE SHALL BE TYPE 2 CEMENT, 4,000 PSI.
 - NO LIFTING HOLES ARE PERMITTED THROUGH WALLS OR TOP SLAB.
 - ALL ABOVE GROUND PIPING TO BE FLANGED.
 - ALL TAPS TO BE MADE WITH A SS TAPPING SADDLE.
 - ALL ENCLOSURE PENETRATIONS SHALL BE MADE ON THE BOTTOM OF THE ENCLOSURE. TOP AND SIDE PENETRATIONS ARE NOT PERMITTED EXCEPT ON TVSS. USE MYERS HUBS EXCEPT BETWEEN DISCONNECT AND TVSS.
 - ALL BOXES AND ENCLOSURES TO BE NEMA 4X 316 SS.
 - RACK TO UTILIZE SS STRUT CHANNEL, SS HARDWARE AND VINYL ENDCAPS.
 - FINISHED GRADE INSIDE THE FENCED AREA SHALL BE MINIMUM OF 6" ABOVE THE 100YR FLOOD ELEVATION. LIFT STATION AREA SHALL BE GRADED TO CARRY ALL SURFACE RUNOFF AWAY FROM WETWELL.
 - WET WELL LINER SHALL BE AGRU-SURE GRIP LINER OR APPROVED EQUIVALENT.
 - WET WELL SHALL NOT EXCEED 25' IN DEPTH MAX.

PUMP DATA	
WETWELL INSIDE DIA.	---
---	SUBMERSIBLE PUMPS
MODEL NUMBER	---
IMPELLER	--- R.P.M. ---
PUMP SIZE	--- HORSE POWER ---
G.P.M.	--- T.D.H. ---
ELECTRICAL REQUIREMENTS	---
	*

*NOTE: ELECTRICAL REQUIREMENT TO BE VERIFIED BY CONTRACTOR.

ALL DESIGNS SHALL REFERENCE WRITTEN SPECIFICATIONS